

UCS GW...

zone 1	zone 2	Ex de mb IIC	II2GD	-40°C	T4 (130°C)	-20°C	T6 (80°C)
zone 21	zone 22	Ex e [ia] IIC	II2GD	+80°C		+40°C	
		Ex ia IIC	II2GD			-40°C	T5 (95°C)
			IP66			+60°C	

PULSANTIERE

CONTROL STATION

Unità di comando, controllo e segnalazione. Control, monitoring and signalling units.

Le unità di comando, controllo e segnalazione UCS... sono utilizzate per la realizzazione di quadri di comando che, ubicati in prossimità delle utenze elettriche comandate, consentono un corretto funzionamento dell'impianto elettrico e garantiscono la sicurezza del personale in caso di manutenzione sull'impianto. Esse offrono protezione e controllo di apparecchiature elettriche e circuiti di comando ubicati in zone a rischio d'esplosione e in ambienti particolarmente aggressivi. Vengono impiegate per il contenimento di apparati elettrici come interruttori, segnalatori, teleruttori, trasformatori, componenti analogici, digitali, ecc... con la possibilità di avere il controllo esterno tramite gli operatori installati su coperchio quali leve di comando, pulsanti, spie di segnalazione ecc... Kroma mec realizza a richiesta l'intero cablaggio di una o più custodie su specifica richiesta del cliente, realizzando batterie per quadristica anche di estrema complessità con la possibilità di effettuare tutti i test di collaudo.

Control, monitoring and signalling units UCS... are used to produce control boards that, when positioned near the electrical equipment being controlled, enable the electrical system to operate correctly and guarantee the safety of personnel when maintenance is being performed on the system. They offer protection and control for electrical equipment and control circuits located in explosion hazard areas and in particularly aggressive environments. They are used to hold electrical equipment, such as switches, indicators, contactors, transformers, analogue and digital components, etc... with the option of external control by using lid-mounted control and signalling devices, such as control levers, pushbuttons, indicator lights, etc.... Kroma mec realizes on request full cabling for one or more enclosures tailored to your specific requirements, producing panel boards including even extremely complex solutions and providing a full inspection and testing service on request.





Stock	Codice / Code	Dimensioni esterne External Dimensions			Dimensioni interne Internal Dimensions			Fissaggio Mounting		Entrate coperchio Cover Entries
		H	W	D	h	w	d	H+	W+	
	GWC 99	90	90	75	78	78	52	74	74	0
+++	GWM 99	95	95	63	87	87	44	55	80	1
	GWC 1111	110	110	85	98	98	65	94	94	1
+++	GWR 1111	110	110	86	102	102	64	96	96	1
	GWC 1414	147	147	100	135	135	79	131	131	4
+++	GWM 1414	140	140	82	132	132	61	95	122	4
+++	GWR 178	175	85	120	166	76	105	123	72	2
+++	GWC 1711	170	110	85	158	98	63	154	94	4
+++	GWR 1717	175	175	120	166	166	105	123	162	4
+++	GWC 3014	305	147	110	289	131	92	285	127	10
+++	GWR 3617	360	175	120	351	166	105	308	162	10
+++	GWC 3023	305	230	110	289	214	92	285	210	12
+++	GWC 3023A	305	230	190	289	214	172	285	210	12
+++	GWR 3636	360	360	120	351	351	105	308	346	24
+++	GWC 4730	470	305	195	454	289	175	450	285	30
+++	GWC 6230	620	305	185	601	286	156	560	285	40
	GWE 87	80	75	55	48	58	66	68	45	0
	GWE 87A	80	75	75	48	58	66	68	45	0
	GWE 117	110	75	75	78	58	66	98	45	1
	GWE 167	160	75	75	128	58	66	148	45	2
	GWE 197	190	75	75	158	58	66	178	45	3
	GWE 237	230	75	75	198	58	66	218	39	4
+++	GWE 1212	120	122	90	102	104	80	82	106	2
	GWE 2212	220	120	90	190	102	80	204	82	6
	GWE 1616	160	160	90	142	112	80	140	110	4
	GWE 2616	260	160	90	212	142	80	240	110	6
	GWE 3616	360	160	90	312	142	80	340	110	10
	GWE 5616	560	160	90	512	142	80	540	110	18
	GWE 2520	250	200	120	230	180	110	230	180	10
	GWE 2525	250	255	120	230	235	110	200	235	12
	GWE 2525A	250	255	160	230	235	144	200	235	12
	GWE 4025	400	250	120	380	230	110	380	200	24
	GWE 4025A	400	250	160	380	230	144	380	200	24
	GWE 6025	600	250	120	580	230	110	580	200	40
	GWE 6025A	600	250	160	580	230	144	580	200	40
	GWE 4040	400	400	120	385	380	110	355	380	42
	GWE 4040A	405	400	165	385	380	154	355	380	42

CODICE / CODE	PROTEZIONE / PROTECTION
GWM - GWR - GWC	IP66
GWE	IP65

+++ PRODOTTI DISPONIBILI A MAGAZZINO
+++ PRODUCTS AVAILABLE IN STOCK



GWM

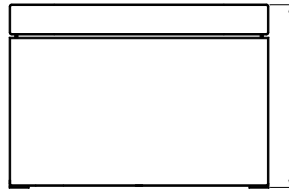
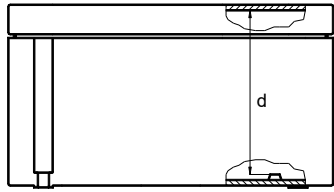
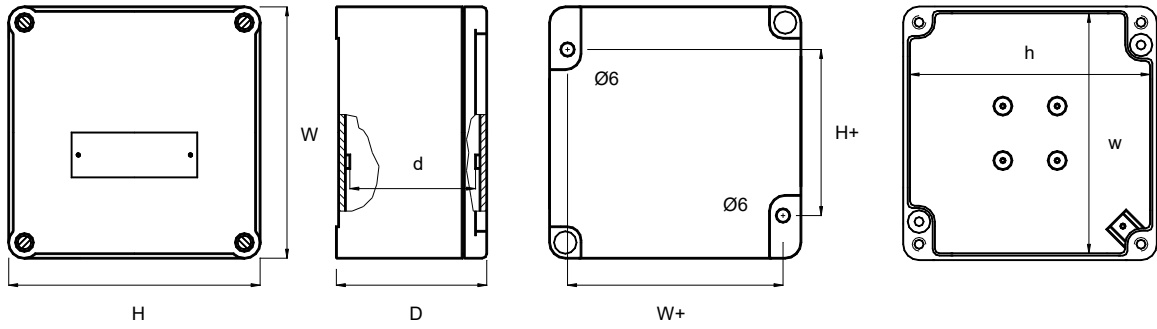

GWR

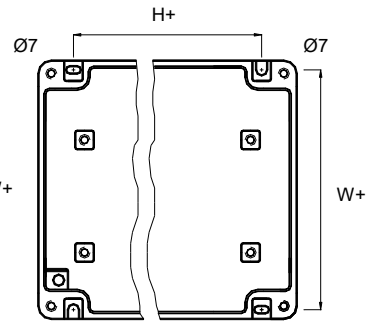
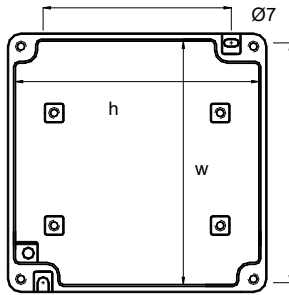
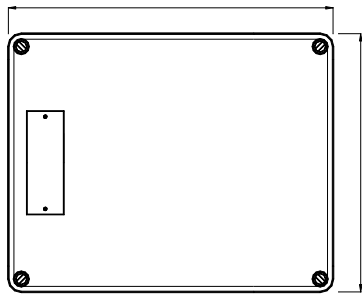

GWR178
GWR1717

GWR3617
GWR3636

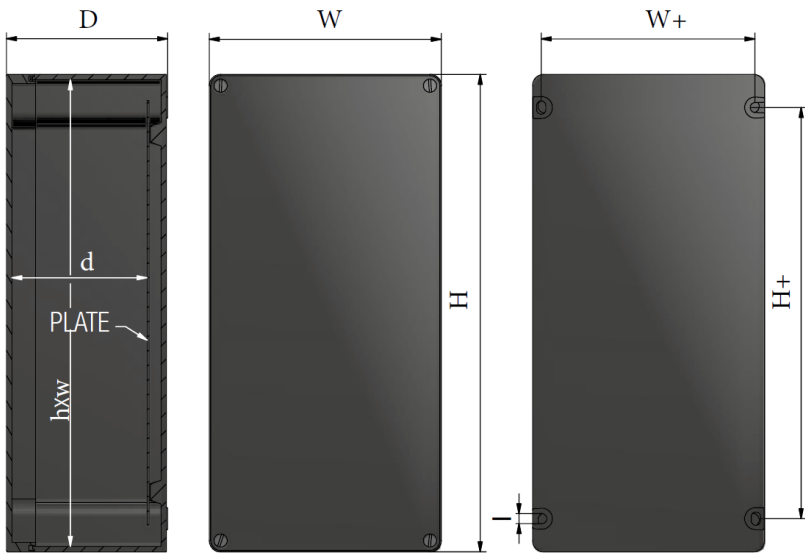

BACK SIDE
FIXING DETAIL

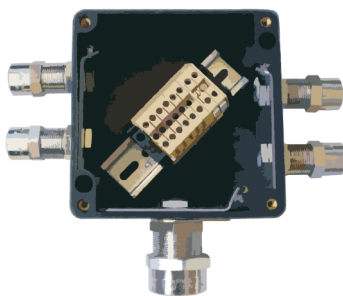

CERNIERE - HINGES





GWC99

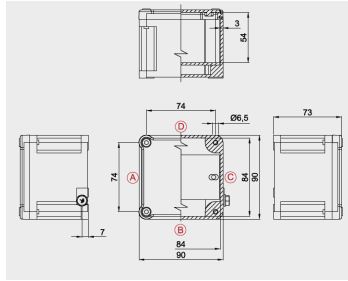

GWC111

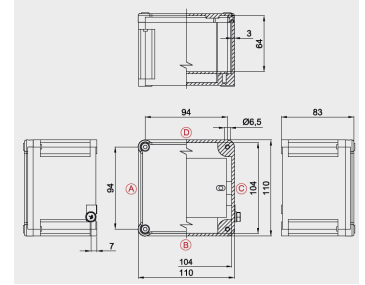

GWC1711

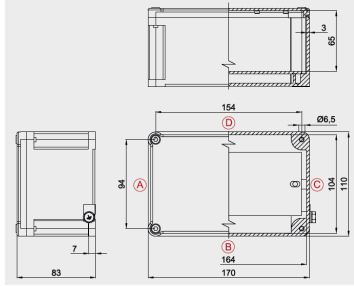

GWC1414

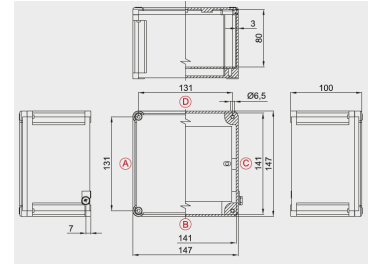

GWC3014

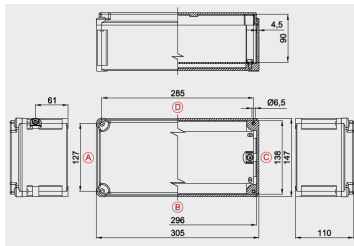

GWC3023

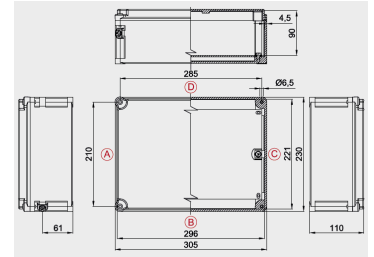

GWC3023A

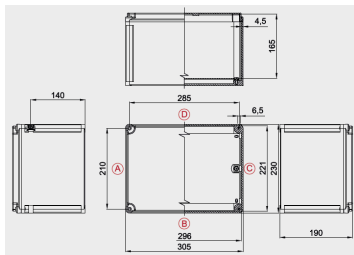

GWC4730

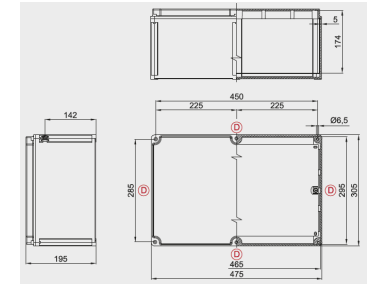

GWC6230



CERNIERE - HINGES

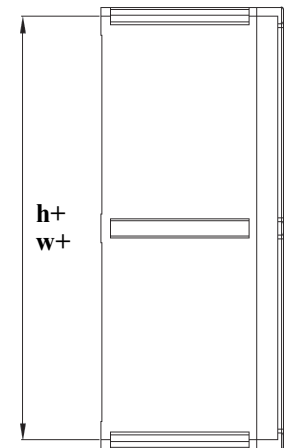
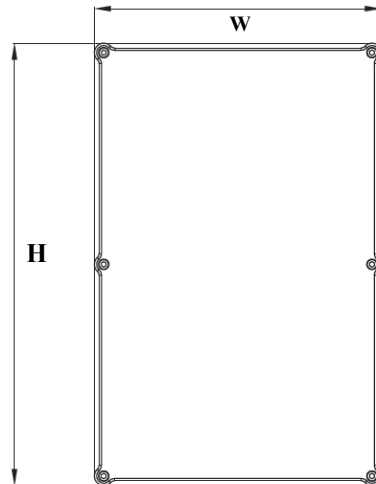
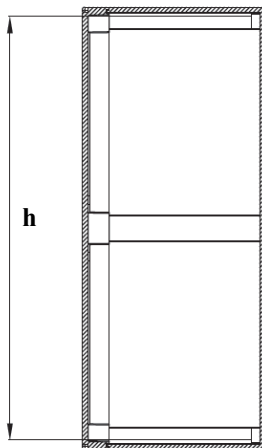
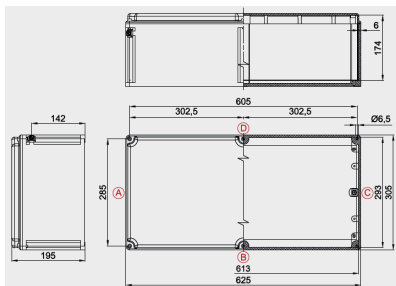
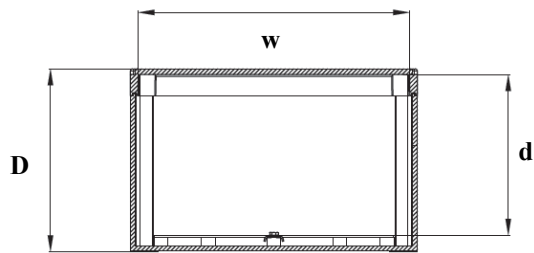

GWE

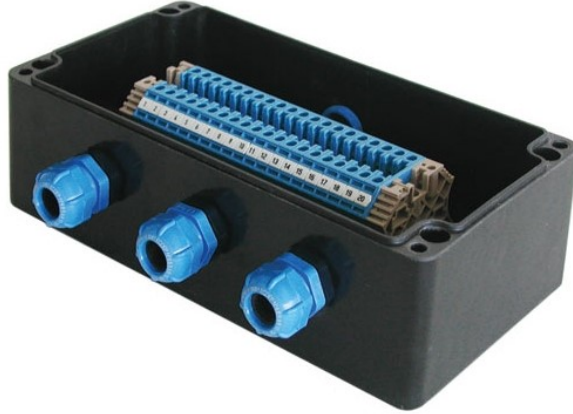

CERNIERE - HINGES

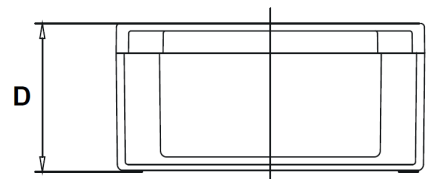
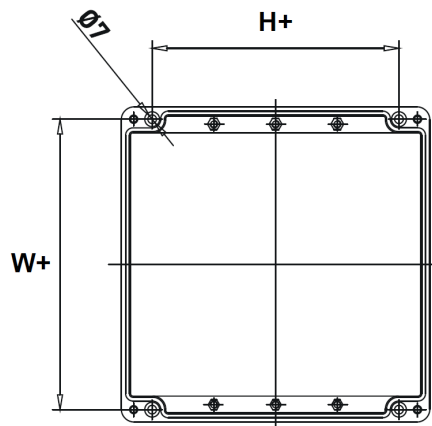
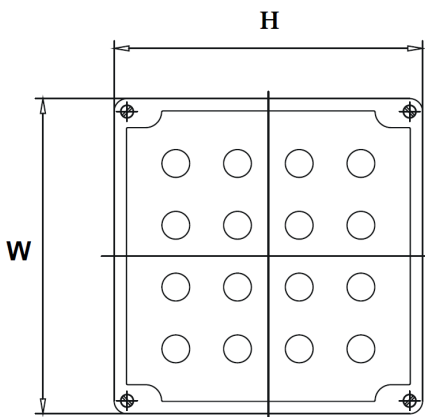



CONTACT (NO - NC) Exde IIC

**Electrical Features
Caratteristiche elettriche**

Ith = 10 A; Ui = 415 V

AC Ue = 380 V; Ie = 1,9 A or
Ue = 240 V; Ie = 3 A or
Ue = 120 V; Ie = 6 A

DC Ue = 250 V; Ie = 0,27 A or
Ue = 125 V; Ie = 0,55 A or
Ue = 24 V; Ie = 2,87 A



LED Exe mb IIC

**Electrical Features
Caratteristiche elettriche**

Rated voltage 24..254 VAC/DC
Maximal current 2... 10 mA

Or

Rated voltage 6..24 VAC/DC
Maximal current 14... 21 mA

Durability 100.000 hours

PUSH BUTTON

Spring return, flush actuator



Spring return, projecting actuator



**COLOR AVAILABLE
COLORI DISPONIBILI**

**BIANCO - WHITE
NERO - BLACK
VERDE - GREEN
ROSSO - RED
GIALLO - YELLOW
BLU - BLUE**



**"Push-push" to release,
flush actuator**



**"Push-push" to release,
projecting actuator**



**Push buttons
With silicone boot**



**EMERGENCY STOP MUSHROOM
SNAP ACTION Ø40mm**

**Type of actuator
"Push-push"**



**Type of actuator"
With key 455**



**Type of actuator"
Turn to release**



SELECTOR SWITCHES

Selector switches with Standard handle



Selector switches with long handle



Selector switches with wheel handle



2 stay put
3 stay put
3 spring return to center
3 spring return from left to center
3 spring return from right to center
2 spring return right and left
2 spring return

SELECTOR SWITCHES KEY

JOYSTICK



This contact is actuated on LEFT and RIGHT position



2 stay put key withdrawal in left position
2 spring return form right to left
2 stay put key withdrawal in both position
3 stay put key withdrawal in 3 position
3 stay put key withdrawal in center position
3 stay put key withdrawal in left or right position
3 stay put key withdrawal in left position
3 stay put key withdrawal in right position
3 spring return form left to center
3 spring return to center
3 spring return form right to center key withdrawal in center position
3 spring return form right to center key withdrawal in left position

LED PILOT LIGHT

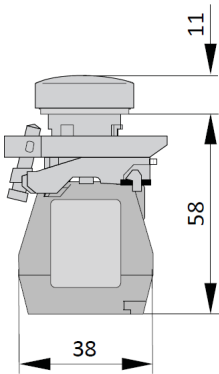

**COLOR AVAILABLE
COLORI DISPONIBILI**

BIANCO - WHITE
NERO - BLACK
VERDE - GREEN
ROSSO - RED
GIALLO - YELLOW
BLU - BLUE

ILLUMINATED BUTTONS

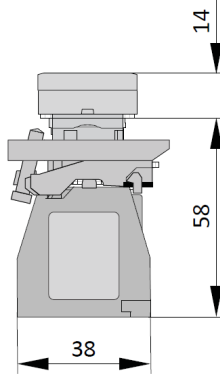

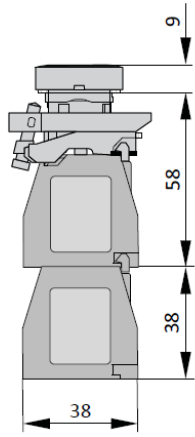
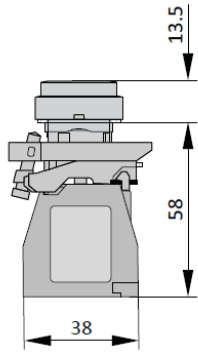
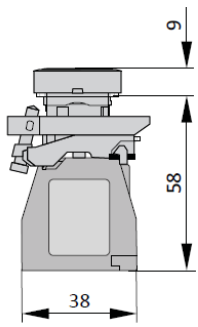

Push button with 2 rows of contacts

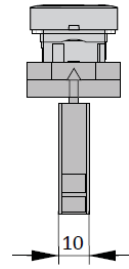

Push button with 1 contact

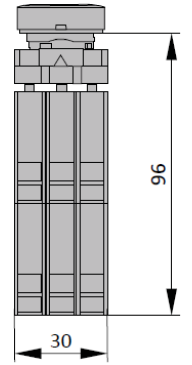

Push button with 2 rows of 3 contacts

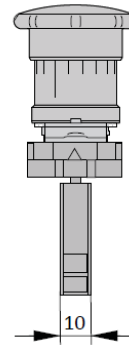
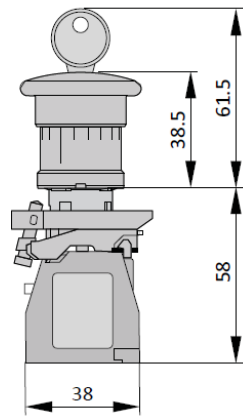
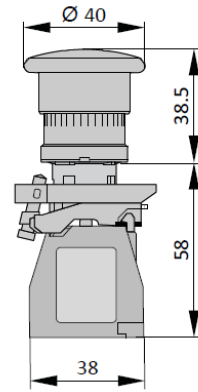
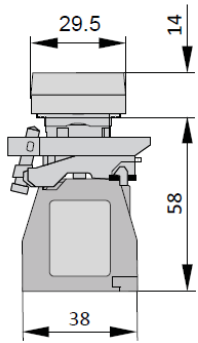

Push button with 1 contact

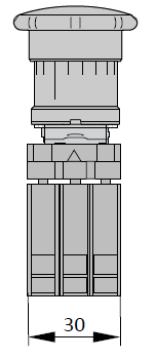

Push button with 1 row of 3 contacts

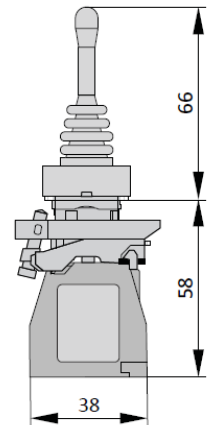
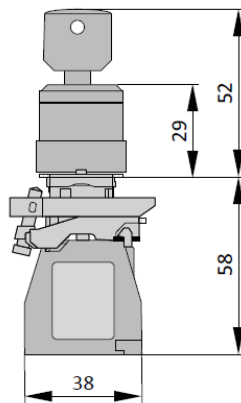
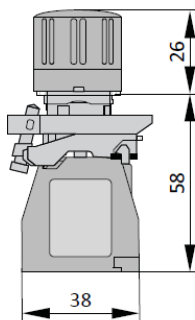
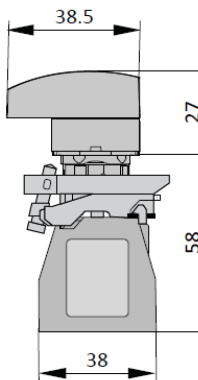
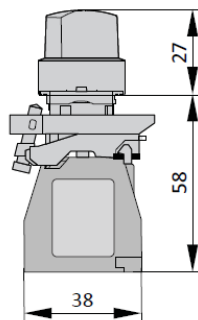

Tipo Type	FORATURE CORPO CASSETTA - HOLE BODY JBOX																			
	Side - lato W										Side - lato H									
	MASSIMA QUANTITA FORI PER LATO MAX QTY HOLE FOR SIDE										MASSIMA QUANTITA FORI PER LATO MAX QTY HOLE FOR SIDE									
	M12	M16 3/8"	M20 1/2"	M25 3/4"	M32 1"	M40 1 1/4"	M50 1 1/2"	M63 2"	M75 2 1/2"	M85 3"	M12	M16 3/8"	M20 1/2"	M25 3/4"	M32 1"	M40 1 1/4"	M50 1 1/2"	M63 2"	M75 2 1/2"	M85 3"
GWC99			1	1																
GWM99	3	2	1	1							4	2	2	1						
GWC1111			2	1	1	1														
GWR1111	5	4	2	1	1						5	4	2	1	1					
GWC1414			3	2	2	1	1													
GWM1414	6	5	3	2	1						8	6	3	2	2					
GWR178	5	3	2	2							12	9	6	4	2	1	1	1		
GWC1711			2	1	1	1							3	3	2	2				
GWR1717	15	12	8	4	2	1	1	1			12	9	6	6	3	2	2	1		
GWC3014			3	2	2	1	1						10	5	5	4	3			
GWR3617	15	12	6	6	3	2	2	1			33	27	14	12	7	4	4	3		
GWC3023			7	4	3	3	2						10	5	5	4	3			
GWC3023A			16	12	9	6	4	4	1	1			24	15	14	8	6	6	2	2
GWR3636	24	21	10	12	5	3	3	2			33	27	14	12	7	4	4	3		
GWC4730			24	15	14	8	6	6	2	2			32	24	18	12	8	8	4	2
GWC6230			18	15	10	8	6	3	2	2			33	30	16	14	12	6	4	4
GWE87	2	2	1								4	2	1	1						
GWE117	2	2	1								6	6	3	2	1					
GWE167	2	2	1								10	10	5	3	2					
GWE197	2	2	1								14	12	6	4	3					
GWE237	2	2	1								16	12	6	4	2					
GWE1212	5	5	2	1	1						6	5	2	1	1					
GWE2212	5	4	2	1	1						14	14	9	4	3					
GWE1616	6	6	4	2	1						12	8	6	3	2	1				
GWE2616	6	6	4	2	1						26	16	12	6	4	3				
GWE3616	6	6	4	2	1						38	22	18	9	6	4				
GWE5616	6	6	4	2	1						58	36	28	14	8	6				
GWE2520	14	14	9	4	3						21	15	8	6	3	2	2	1		
GWE2525	21	15	8	6	3	2	2	1			24	18	10	8	4	3	2	2		
GWE4025	21	15	8	6	3	2	2	1			42	33	18	16	6	5	4	3		
GWE6025	21	15	8	6	3	2	2	1			60	40	30	28	10	8				
GWE4040	42	33	18	16	6	5	4	3			42	33	18	16	6	5	4	3		

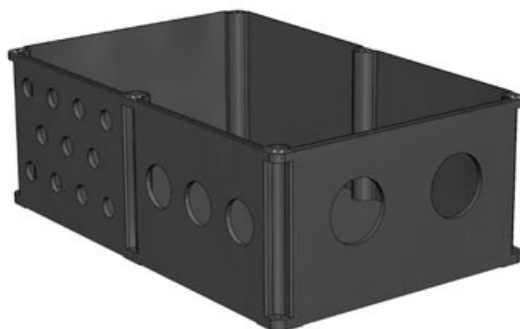

	MASSIMO NUMERO MORSETTI - MAX QTY TERMINAL														
	SEZIONE MORSETTI - TERMINAL CROSS														
	1,5	2,5	4	6	10	16	25	35	50	70	95	120	150	185	240
GWC99	9	7	6	5											
GWM99	9	7	6	5											
GWC1111	13	10	8	7	5										
GWR1111	12	12	8	8	6	5	3	3							
GWC1414	22	16	14	11	9	7	5	5							
GWM1414	18	18	10	10	8	7	5	5							
GWR178	18	18	10	10	8	7	5	5							
GWC1711	27	21	17	14	11	9									
GWR1717	2x18	2x18	2x10	2x10	10	8	6	6	4	4					
GWC3014	57	44	37	30	24	20	15								
GWR3617	2x48	2x48	2x16	2x16	2x16	20	12	12	4	4					
GWC3023	2x58	2x44	2x37	2x30	2x24	2x20	2x15								
GWC3023A	2x58	2x44	2x37	2x30	2x24	2x20	2x15								
GWR3636	3x48	3x48	3x37	3x48	3x34	3x29	2x12	2x12	16	16	4	4	4	4	4
GWC4730	2x97	2x74	2x63	2x51	2x41	2x34	2x25								
GWC6230	2x133	2x101	2x86	2x70	2x56	2x46	2x35								
GWE87	6	6													
GWE117	12	12													
GWE167	22	22													
GWE197	28	28													
GWE237	35	35													
GWE1212	12	12	10	7	6	4	3	3							
GWE2212	31	31	26	20	16	12	9	9							
GWE1616	19	19	16	12	10	7	5	5							
GWE2616	32	32	32	25	20	16	12	12							
GWR3616	58	58	49	38	30	24	18	18							
GWE5616	94	94	81	63	50	41	30	30							
GWE2520	36	36	30	23	19	15	11	11							
GWE2525	36	36	30	23	19	15	11	11							
GWE2525A	36	36	30	23	19	15	11	11							
GWE4025	65	65	54	42	33	27	20	20	11	11	10	10	10	10	
GWE4025A	65	65	54	42	33	27	20	20	11	11	10	10	10	10	
GWE6025	65	65	54	42	33	27	20	20	11	11	10	10	10	10	
GWE6025A	65	65	54	42	33	27	20	20	11	11	10	10	10	10	
GWE4040	65	65	54	42	33	27	20	20	11	11			10	10	
GWE4040A	65	65	54	42	33	27	20	20	11	11			10	10	

Es. 2x22= 2 file da 22 morsetti (totale 44 morsetti). Il numero massimo di morsetti standard è riferito al montaggio di morsetti CABUR e/o WEIDMULLER.

Eg. 2x22= 2 rows of 22 terminals (total 44 terminals). The maximum number of standard terminals refers to the mounting of CABUR and/or WEIDMULLER terminals.

